

**MOUNTING PROCEDURE****KIT WINDSHIELD  
DUCATI MONSTER 696****DN7300****KIT**

X2. BRACKET  
 X2. THICKNESS 16 MM  
 X2. WASHERS Ø 8  
 X2. SCREW 8X45  
 X4. SCREW 5X16  
 X4. AUTOLOCK NUT Ø 5  
 X4. WASHER Ø 5  
 X4. WASHER IN TEFLON Ø 5  
 X4. RUBBER WASHER  
 X1. BARRACUDA WINDSHIELD/SCREEN

WWW.BARRACUDAMOTO.COM

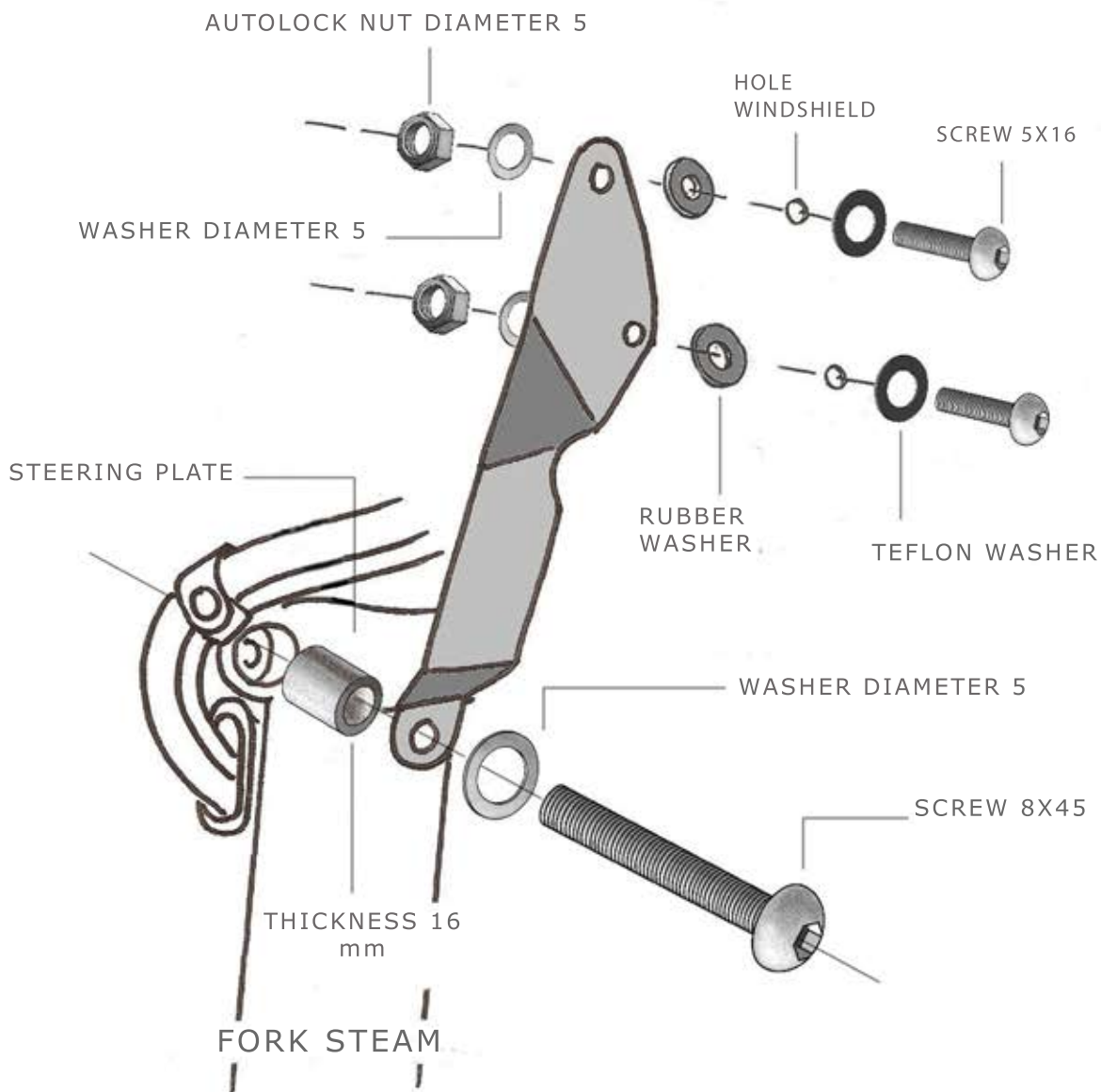

APPLY THE TWO BRACKETS ON THE LOCK OF STEERING PLATE, MOUNT THE BRACKET WITHOUT LOCK TOO MUCH, MOUNT THE PLEXIGLASS ON THE BRACKET USING THE SCREWS AND WASHERS LIKE PROCEDURE.

POSITION THE WINDSHIELD/SCREEN BUT DON'T LOCK ALL.

DON'T LOCK TOO MUCH THE SCREWS 5X16 TO AVOID DAMAGES SCREEN AFTER AND DURING THE LOCKING..

NOTE: THE PICTURE IS THE MOUNTING LEFT SIDE.

**ISTRUZIONI DI MONTAGGIO****KIT CUPOLINO  
DUCATI MONSTER 696****DN7300****KIT**

X2. STAFFE  
 X2. SPESSORI 16 MM  
 X2. RONDELLE Ø 8  
 X2. BRUGOLE 8X45  
 X4. BRUGOLE5X16  
 X4. DADI Ø 5 "AUTOBLOCCANTI"  
 X4. RONDELLA Ø 5  
 X4. RONDELLA Ø 5 TEFLON  
 X4. RONDELLA IN GOMMA  
 X1. CUPOLINO BARRACUDA

WWW.BARRACUDAMOTO.COM

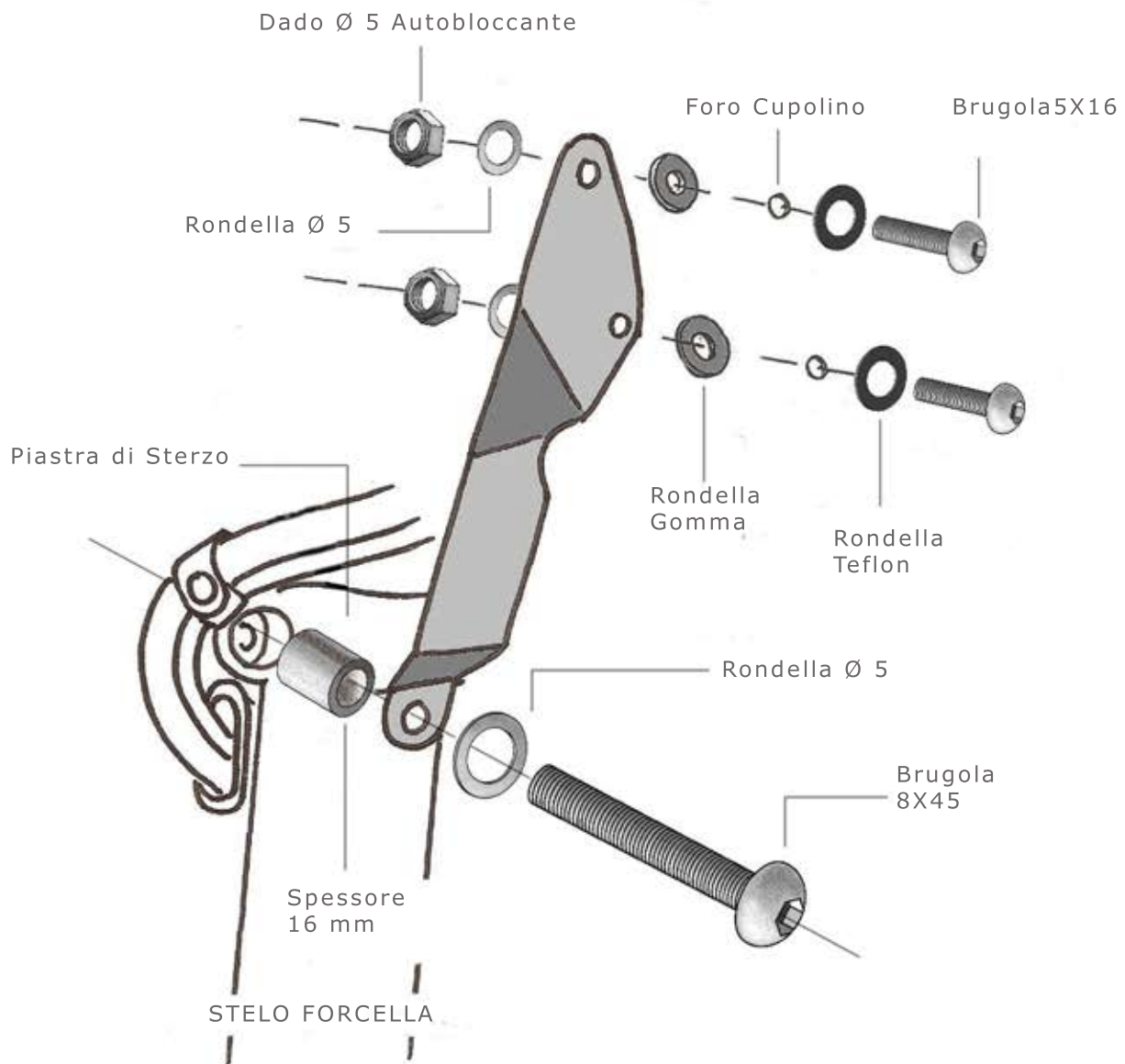

APPLICARE LE DUE STAFFE SULLA CHIUSURA DELLA PIASTRA DI STERZO, MONTARE LE STAFFE SENZA SERRARLE, MONTARE IL PLEXIGLASS SU DI ESSE METTENDO LA VITERIA E LE RONDELLE COME DA PROCEDURA. POSIZIONARE IL CUPOLINO E STRINGERE IL TUTTO. NON SERRARE ECCES- SIVAMENTE LA VITERIA 5X16 PER EVITARE ROTTURE DEL CUPOLINO NEL SERRAGGIO.  
 NOTE: L'ILLUSTRAZIONE RAPPRESENTA IL MONTAGGIO LATO SINISTRO