

ASSEMBLING INSTRUCTION

WINDSHIELD

YMTR9300-18

WWW.BARRACUDAMOTO.COM

LEGEND

- | | | |
|--|---|--|
| 1. BRACKET
STAFFA
SOPORTE
HALTERUNG
SUPPORT | 4. SPECIFIC THICKNESS H10MM
SPESSORE SPECIFICO H10MM
ESPACIADOR H10MM
ABSTANDSHALTER H10MM
ESPACEUR H10MM | 7. ALLEN SCREW M5X30
VITE A BRUGOLA M5X30
TORNILLO ALLEN M5X30
INBUSSCHRAUBE M5X30
VIS ALLEN M5X30 |
| 2. ALLEN SCREW M5X16
VITE A BRUGOLA M5X16
TORNILLO ALLEN M5X16
INBUSSCHRAUBE M5X16
VIS ALLEN M5X16 | 5. RUBBER WASHERS
RONDELLA GOMMA
ARANDELAS DE CAUCHO
GUMMISCHEIBE
RONDELLE EN CAOUTCHOUC | 8. ALLEN SCREW M5X12
VITE A BRUGOLA M5X12
TORNILLO ALLEN M5X12
INBUSSCHRAUBE M5X12
VIS ALLEN M5X12 |
| 3. THREADED THICKNESSES
SPESSORE FILETTATO
ESPACIADOR ROSCADO
GEWINDE ABSTAND
ESPACEUR FILETE | 6. TEFLON WASHERS
RONDELLA TEFLON
ARANDELAS DE TEFLON
TEFLONSCHIEBE
RONDELLE EN TÉFLON | |

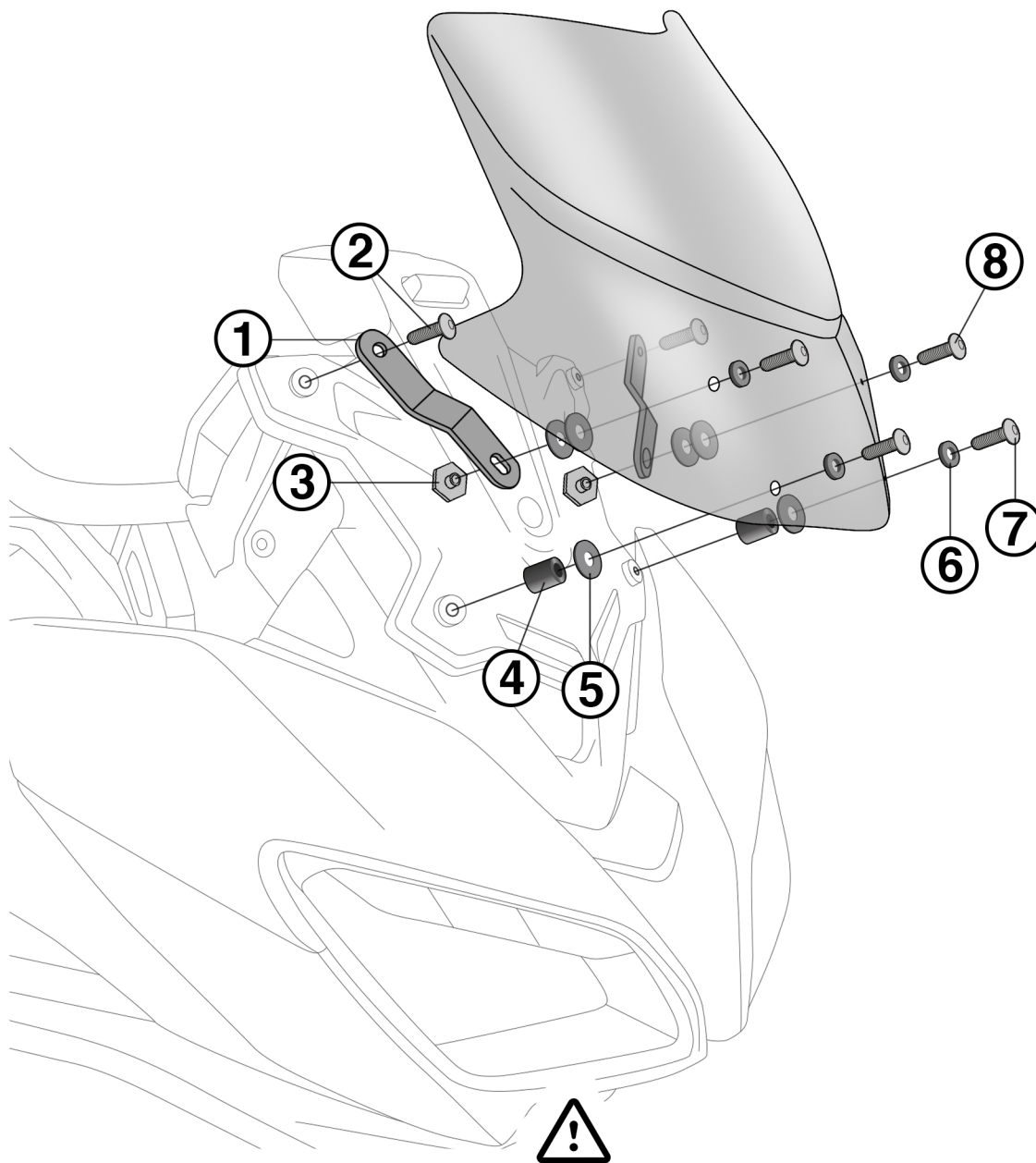

EN: DO NOT THIGTEN IN EXCESSIVE WAY TO AVOID BREAKAGE OF THE WINDSHIELD
IT: NON STRINGERE ECCESSIVAMENTE PER EVITARE ROTTURE DEL CUPOLINO
SP: NO APRETAR DE FORMA EXCESIVA PARA EVITAR LA ROTURA DEL PARABRISAS
DE: NICHT ZU FEST ANZIEHEN, UM EINEN BRUCH DES SCHEINWERFER VERKLEIDUNG ZU VERMEIDEN
FR: NE PAS TROP SERRER POUR ÉVITER DE CASSER LE PARE-BRISE